



Private



Lock Installation Guide

for PTL-3 and PTL-5

INSTALLATION MANUAL

PTL-3/5 PTL-5 COMBINATION LOCK SYSTEM PTL-3R/5R

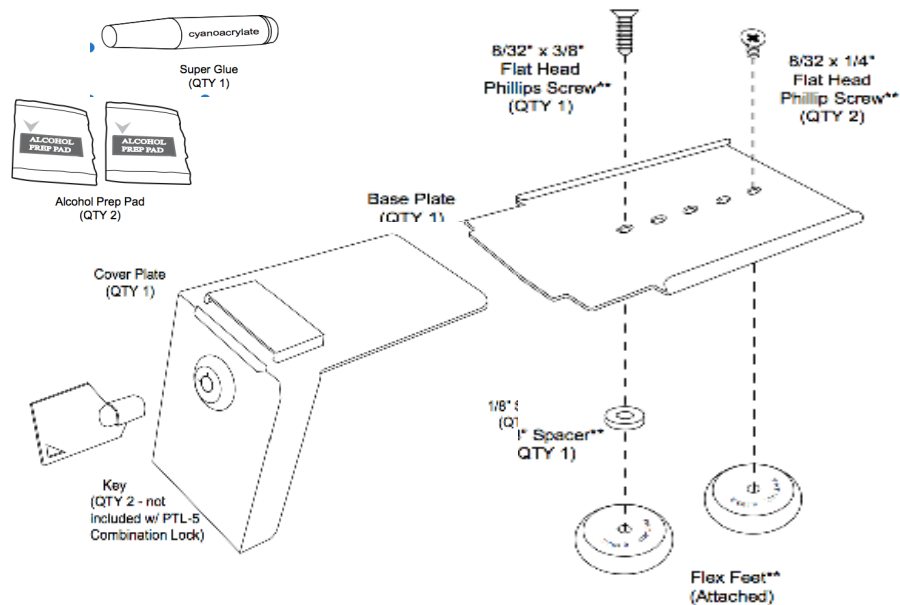

Part List:

1x Super Glue
2x Alcohol prep Pad
1x Cover Plate

2x Key
1x Base Plate
1x Flathead Screw

2x Phillips Screw
1x Spacer
2x Flex Feet

1. Position the PTL lock in different locations around the printer to determine the best location. The flex feet should make full contact with the printer. If the feet are not in full contact with the printer, loosen the screws on the base plate until the feet sit flush with the mounting area. Make sure feet do not cover any vents, openings, or access panels.



2. Trace around the base plate to mark the installation area.

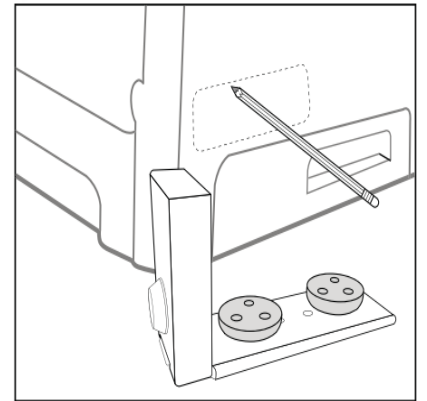

3. Use the provided alcohol wipes to thoroughly clean inside the marked area on the printer as well as the flex feet. (Clean entire surface of rubber on PTL-3R/5R.)

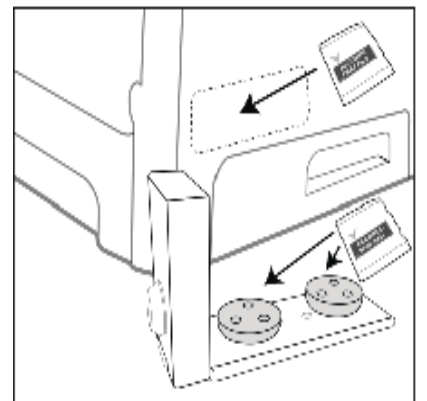

4. Place 7-8 drops of super glue on each flex foot. Apply glue around the perimeter of each flex foot as well as in the middle of each flex foot. For the PTL-3R/5R, apply a bead of glue around the perimeter of the rubber as well as several beads running top to bottom.

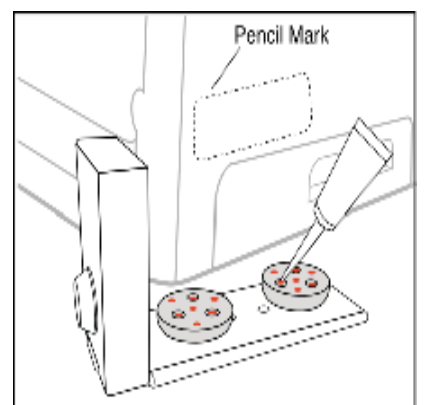

5. Quickly and carefully place the PTL in the marked area on the printer and apply firm and steady pressure for 100 seconds.

After 100 seconds unlock & carefully remove the cover plate to sit undisturbed for 24 hours.

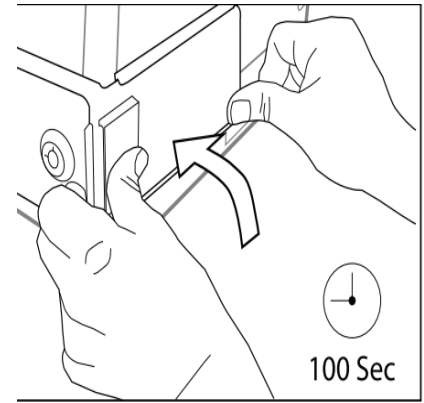

6. After 24 hours slide the cover plate onto the base plate and turn the key. For the combination lock turn the knob and scramble the code.

Your printer is now Secure!

*Note - retighten base plate screws if they are loosened during step 1. Do not overtighten screws

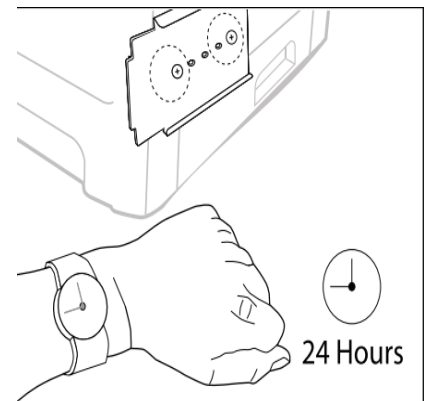

Have you seen our range of Refrigerator Locks?



Refrigerator Cable Lock
£41.99

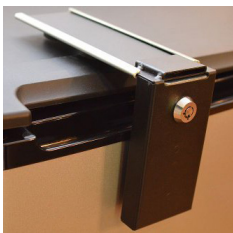

Refrigerator Key Lock
£45.99

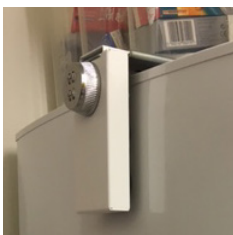

Refrigerator Combination Lock
£53.99



Refrigerator locks can be used to secure prescription drugs in hospitals and nursing homes. Alternatively, it can suit those who have family members with Alzheimers, Autism or Prader-Willi Syndrome helping to prevent overeating.